

STATE OF NEVADA
 COMMISSION ON MINERAL RESOURCES
DIVISION OF MINERALS
 400 W. King Street, Suite 106
 Carson City, Nevada 89703
 (775) 684-7040 | Fax (775) 684-7052
 http://minerals.nv.gov

Date Received: <u>3/27/2018</u>
Approved By: <u>[Signature]</u>
Date Approved: <u>3/27/2018</u>
NDOM NOI#: <u>N 0002</u>

**NOTICE OF INTENT TO DRILL
 DISSOLVED MINERAL RESOURCE EXPLORATION BOREHOLE**

Note: one form per borehole, to be submitted at least five (5) days prior to drilling

Today's Date: 3/23/2018 Intended Start Date: 4/18/2018

Operator Name: Bonaventure Nevada Inc.
 Operator Address: 4235 Christy Way, Reno, Nevada, 89519
 Email Address: rrkern@charter.net

Groundwater Basin Name and Number: _____ Area of Limitations?
Sarcobatus Flat, NV - 146 Yes No

Federal Lands - BLM NVN Number N-94783 3809(NVB0200)
 or
 Non-Federal Lands
 Land owner's name: _____
 APN Number: _____
 Address: _____

Drilling Method: Mud Rotary Rev Circ Air Core
 Sonic Other _____

Diameter (inches): 6 Anticipated Final Depth (feet): 2,000

Location: SE of the 1/4 NW 1/4, Sec 26 T8 N S R 44 E

County: Nye

Global Positioning System (GPS) coordinates and datum for borehole:
Universal Transverse Mercator (UTM) Geographic Coordinate System (decimal degrees)
 UTM East: 498500 or Longitude: _____
 UTM North: 4119000 Latitude: _____
 NAD 83 WGS 84

Drilling Company Name: Harris Exploration
 On-site Driller's Name: Pat Harris
 On-site Driller's License Number: NV 2554

RECEIVED
MAR 27 2018

Submit completed form to: (email) ndom@minerals.nv.gov or (fax) 775-684-7052 **DIVISION OF MINERALS**

----- No Fee Required -----

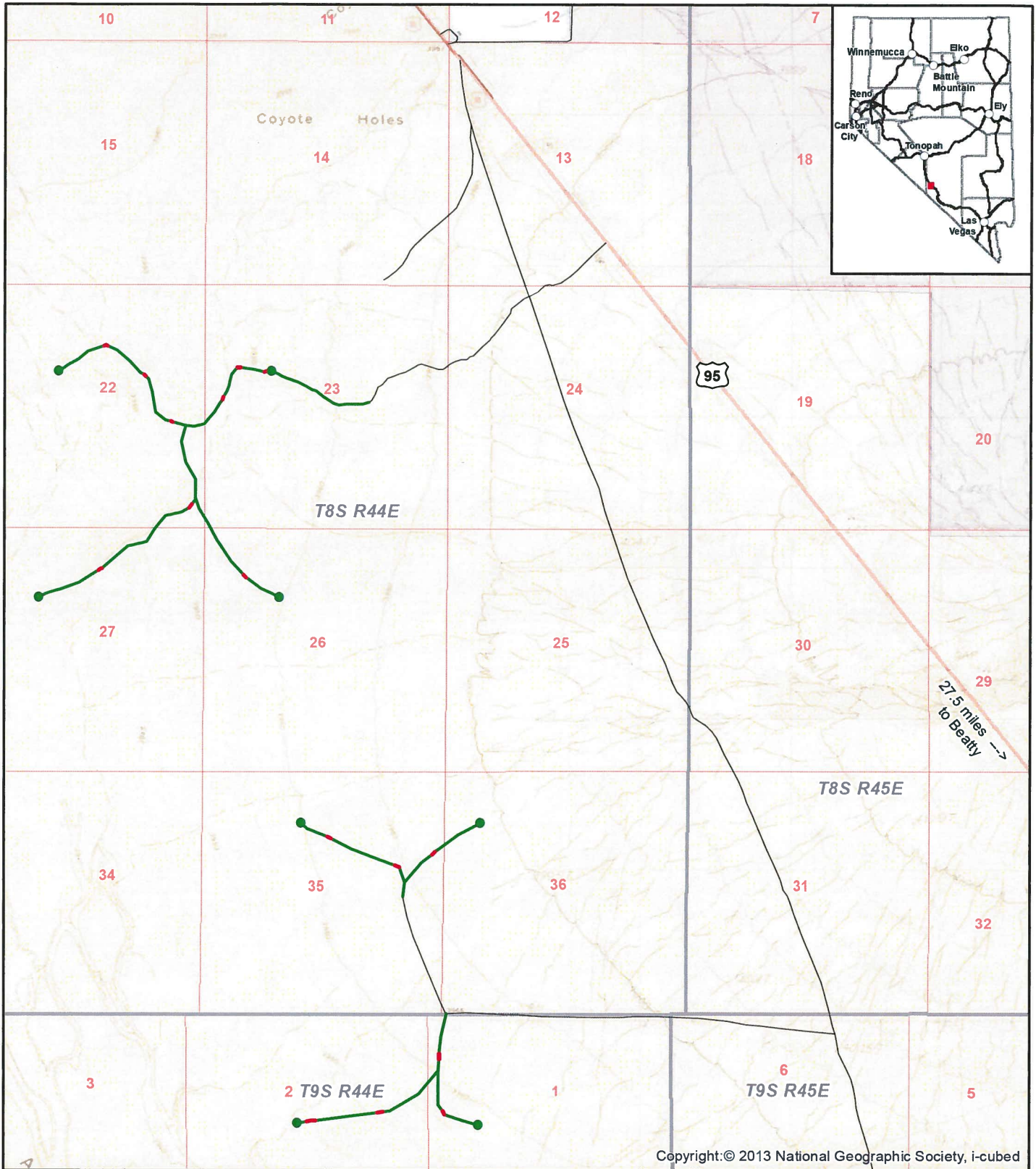

Copyright:© 2013 National Geographic Society, i-cubed

Explanation

- Proposed Drill Site (8)
- Proposed Overland Travel (27,776 Feet)
- Proposed Constructed Road (1,427 Feet)
- Existing Road

Land Status

- Bureau of Land Management
- Department of Defense
- Private

BONAVENTURE NEVADA INC.

BONNIE CLAIRE NOTICE

Project Location and Proposed Activities

Figure 1

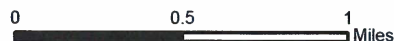

Date: 05/24/2016 Drawn By: JDB
 Revised: 06/01/2016 Project No: 3649
 Base Map: USGS 7.5 quad: Bonnie Claire, Scolya Junction, Springdale NW, Toiyah Peak SW
 File Name: 3649G_BonnieClaire_Notice.mxd

